

# Heater Fire Safety

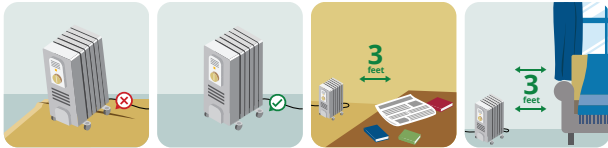

Follow these heating safety tips to help keep your home fire safe this winter.



- ▶ Make sure your heater has been tested by a recognized testing laboratory.
- ▶ Make sure your heater has an automatic shut-off, so if it tips over, it shuts off.
- ▶ Keep anything that can burn, like bedding, clothing and curtains, at least 3 feet away from your heater.
- ▶ Place space heaters on a solid, flat surface.
- ▶ Turn heaters off when you go to bed or leave the room.

# Heater Fire Safety



Follow these heating safety tips to help keep your home fire safe this winter.

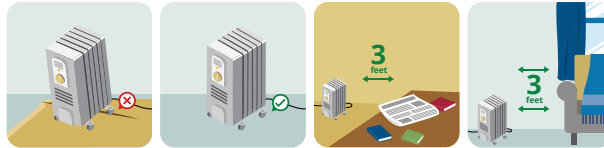

- ▶ Make sure your heater has been tested by a recognized testing laboratory.
- ▶ Make sure your heater has an automatic shut-off, so if it tips over, it shuts off.
- ▶ Keep anything that can burn, like bedding, clothing and curtains, at least 3 feet away from your heater.
- ▶ Place space heaters on a solid, flat surface.
- ▶ Turn heaters off when you go to bed or leave the room.

# Heater Fire Safety



Follow these heating safety tips to help keep your home fire safe this winter.

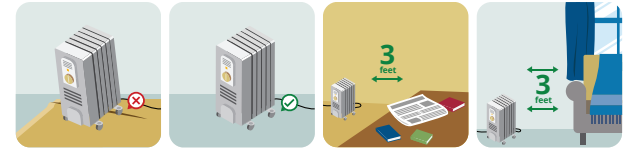

- ▶ Make sure your heater has been tested by a recognized testing laboratory.
- ▶ Make sure your heater has an automatic shut-off, so if it tips over, it shuts off.
- ▶ Keep anything that can burn, like bedding, clothing and curtains, at least 3 feet away from your heater.
- ▶ Place space heaters on a solid, flat surface.
- ▶ Turn heaters off when you go to bed or leave the room.

# Heater Fire Safety

## Space heater safety

- ▶ Do not plug anything else into the same circuit as the one you are using for your space heater. This can cause overheating.
- ▶ Plug portable heaters directly into outlets. Never use an extension cord or power strip.

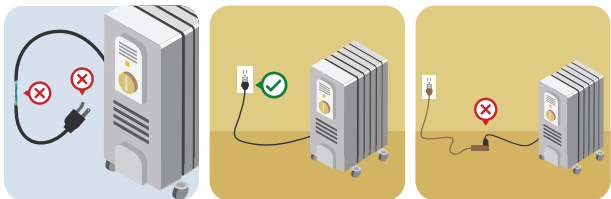

## Kerosene heater safety

- ▶ Always use the proper fuel in your heater.
- ▶ Refuel your heater outside once it has cooled.

# Heater Fire Safety

## Space heater safety

- ▶ Do not plug anything else into the same circuit as the one you are using for your space heater. This can cause overheating.
- ▶ Plug portable heaters directly into outlets. Never use an extension cord or power strip.

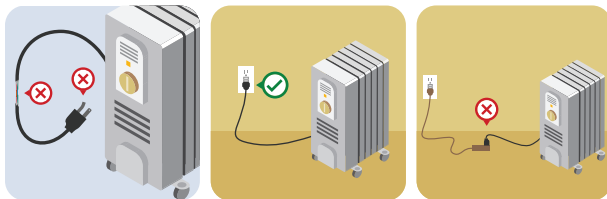

## Kerosene heater safety

- ▶ Always use the proper fuel in your heater.
- ▶ Refuel your heater outside once it has cooled.

# Heater Fire Safety

## Space heater safety

- ▶ Do not plug anything else into the same circuit as the one you are using for your space heater. This can cause overheating.
- ▶ Plug portable heaters directly into outlets. Never use an extension cord or power strip.

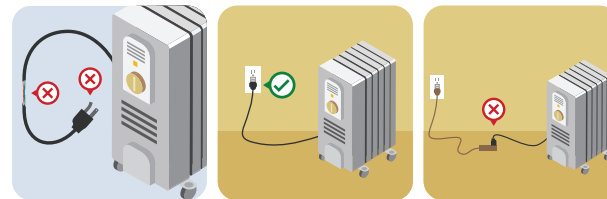

## Kerosene heater safety

- ▶ Always use the proper fuel in your heater.
- ▶ Refuel your heater outside once it has cooled.